



DEVELOPER
Kramer investment corp.
1589 myrtle avenue suite b
eureka, ca 95501
(707)444-2919 office
(707)444-2396 fax
Contacts: Kurt Kramer
Chris Wilkelsen

PROJECT NAME

McKAY RANCH SUBDIVISION
TENTATIVE MAP FOR a
PLANNED DEVELOPMENT
HUMBOLDT COUNTY

APNs: 017-032-0005, 017-071-0484 & 009, 017-072-0402 & 003, 017-070-0407 & 009

SHEET TITLE

**PROPOSED LAND USE
DESIGNATIONS**

PILOT INFORMATION

017-032-0005, 017-071-0484, 017-072-0402 & 003, 017-070-0407 & 009

REVISIONS

| NO. | DATE | DESCRIPTION |
|-----|------|-------------|
| | | |
| | | |
| | | |

WORK LOG

| PROJECT NO. | DATE |
|-------------|----------|
| 14-100 | 03/05/16 |

DRAWN BY: BKO

CHECKED BY: BKO

SUBMITTAL STATUS

PLANNING REVIEW

C1.1

SHEET 2 OF 5

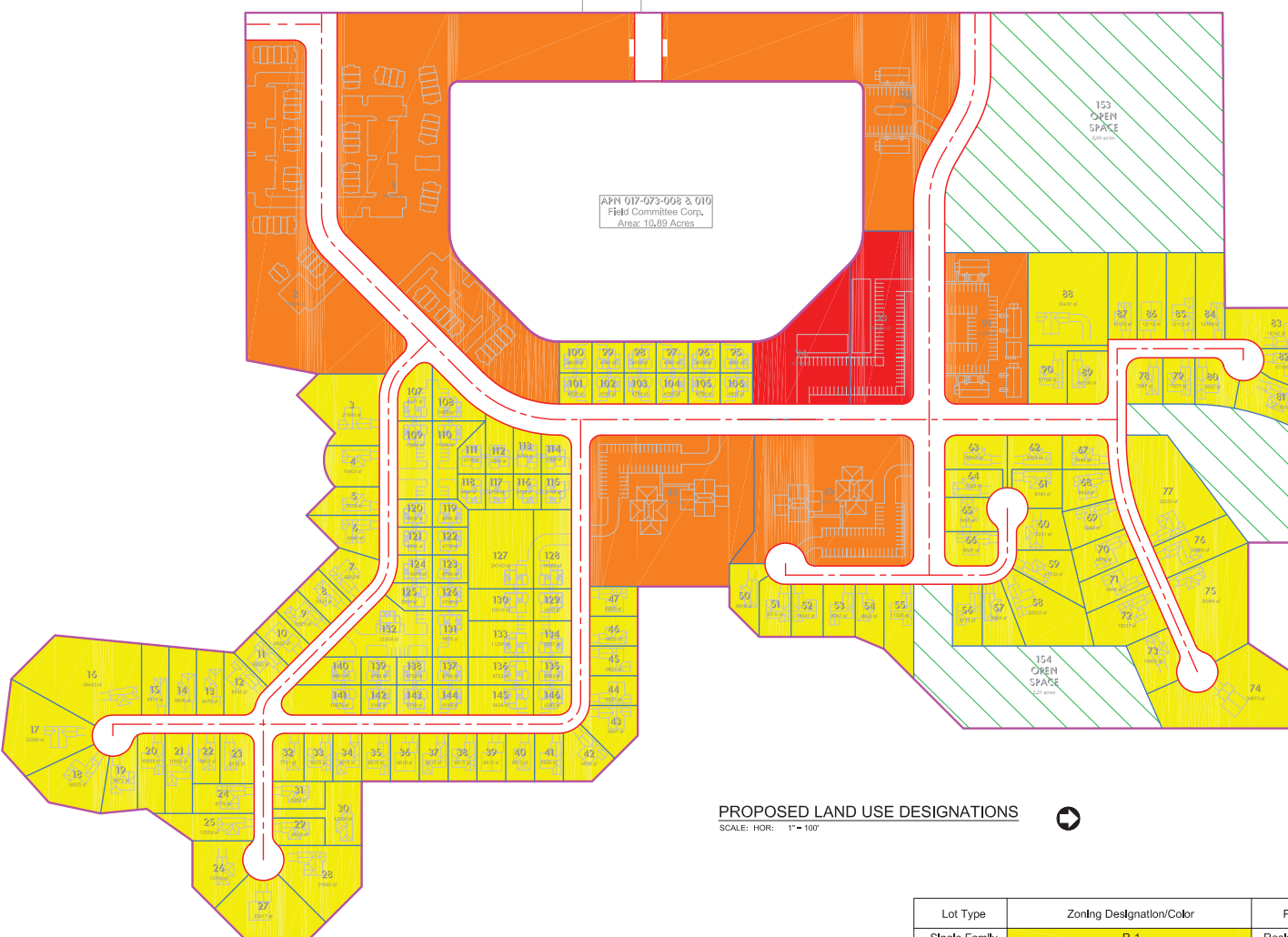

PROPOSED LAND USE DESIGNATIONS

SCALE: HOR: 1" = 100'



| Lot Type | Zoning Designation/Color | Plan Designation |
|-------------------------------|--|--|
| Single Family | R-1 P, GO | Residential, Low Density (RL), 1 - 6 units/acre |
| | Residential Single Family (R-1) w/Planned Development (P), and Greenway and Open Space (GO) Combining Zones | |
| Multi Family Lots 1, 8 & 9 | R-4 P, GO | Residential, Multiple Family (RM), 7 - 16 units/acre |
| | Apartment Professional (R-4) w/Planned Development (P), and Greenway and Open Space (GO) Combining Zones | |
| Commercial Lots 4 | C-1 P, GO | Commercial General (CG) |
| | Neighborhood Commercial (C-1) w/Planned Development (P), and Greenway and Open Space (GO) Combining Zones, C-1/P, GO | |